

VETERAN'S MEMORIAL PARK

City Of Richfield, MN



VETERAN'S MEMORIAL PARK

City Of Richfield, MN



NOTE:
4" DRAIN TILES AT
10' O.C. WILL BE
PROVIDED, PIPING
OUTSIDE OF CURB
IS BY OWNER

COZY COCOON

ACTIVO BAMBINO TOT SPOT #ACT1301

2656 SF OF ENGINEERED WOOD FIBER ON GEOTEXTILE FABRIC

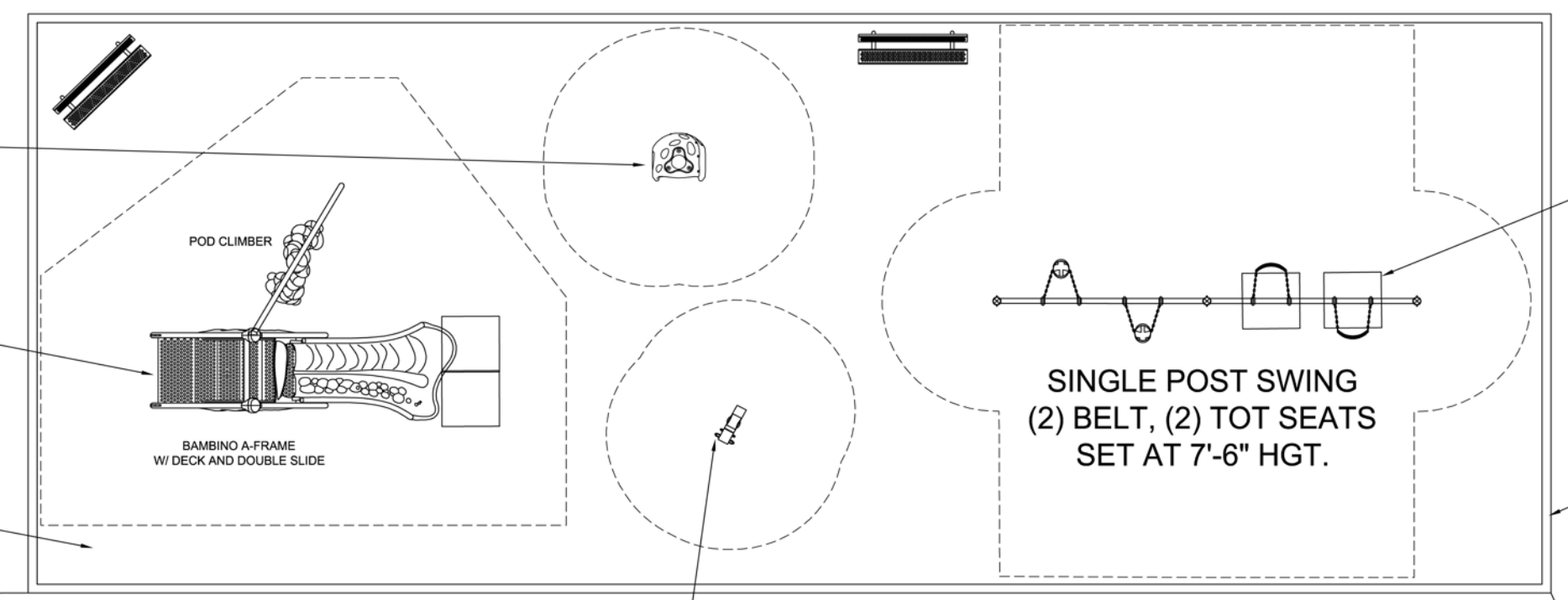

(14) WEAR MATS AT SWINGS AND SLIDE EXITS, TYP.

232 LF OF NEW CONC. CURBING



FITNESS EQUIPMENT:
ELLIPTICAL, LEG LIFT,
PULL-UP AND PUSH-UP

12,421 SF OF ENGINEERED WOOD FIBER ON GEOTEXTILE FABRIC

TURTLE SPRING RIDER

(6) 6' BENCHES WITH BACKS #ZZXX1410

434 LF OF NEW CONC. CURBING

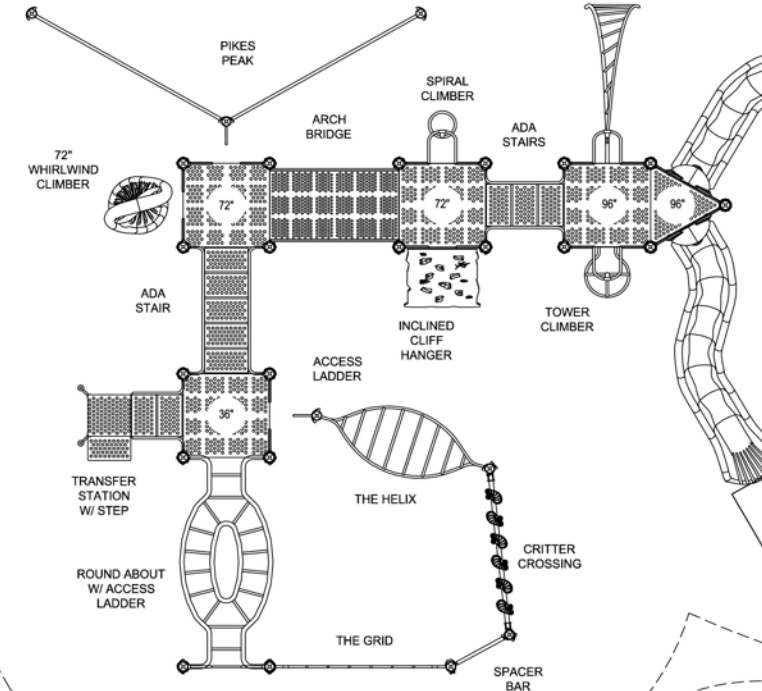
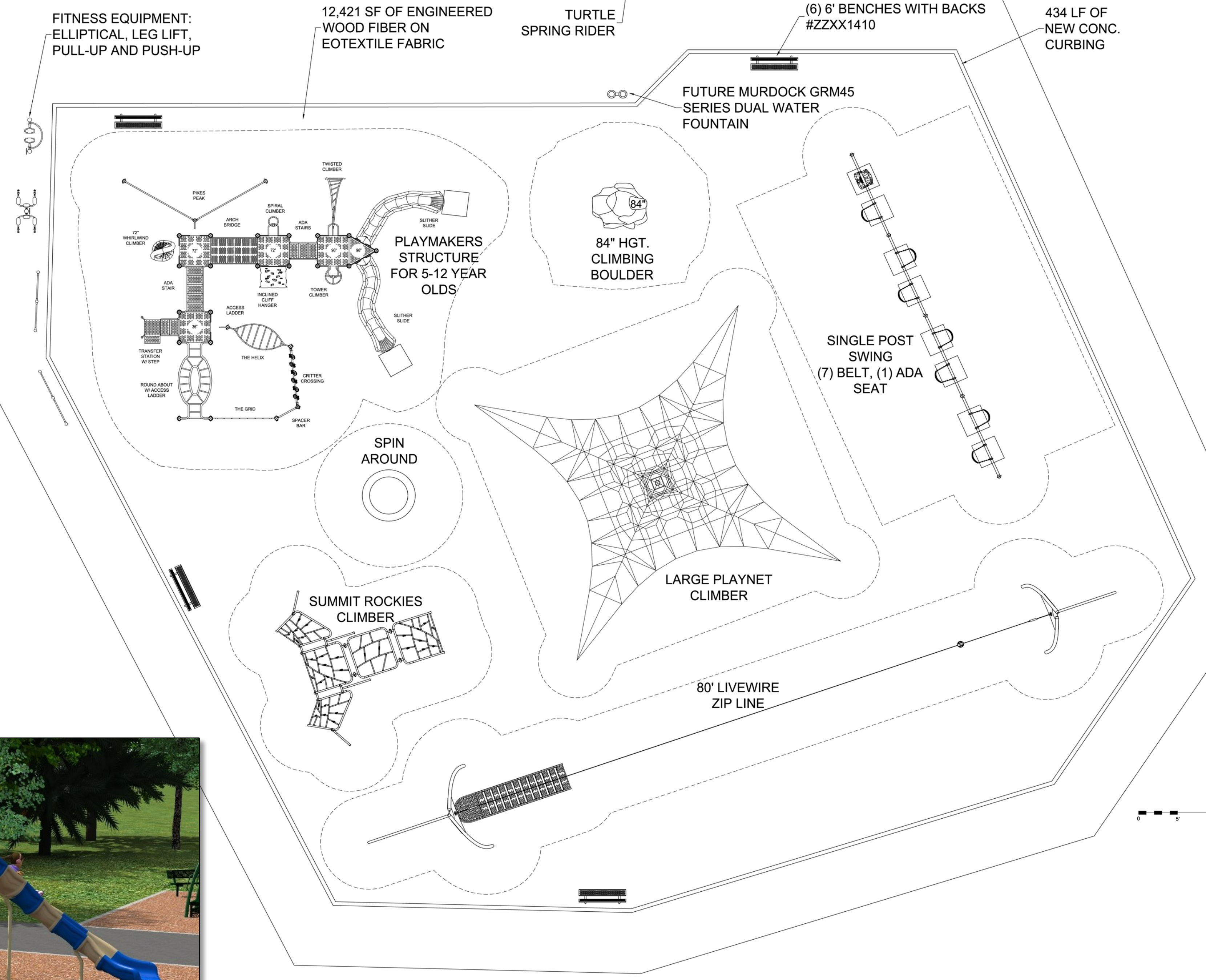

PLAYMAKERS STRUCTURE FOR 5-12 YEAR OLDS

84" HGT. CLIMBING BOULDER

LARGE PLAYNET CLIMBER

SUMMIT ROCKIES CLIMBER

SPIN AROUND

SINGLE POST SWING (7) BELT, (1) ADA SEAT

80' LIVEWIRE ZIP LINE

FUTURE MURDOCK GRM45 SERIES DUAL WATER FOUNTAIN

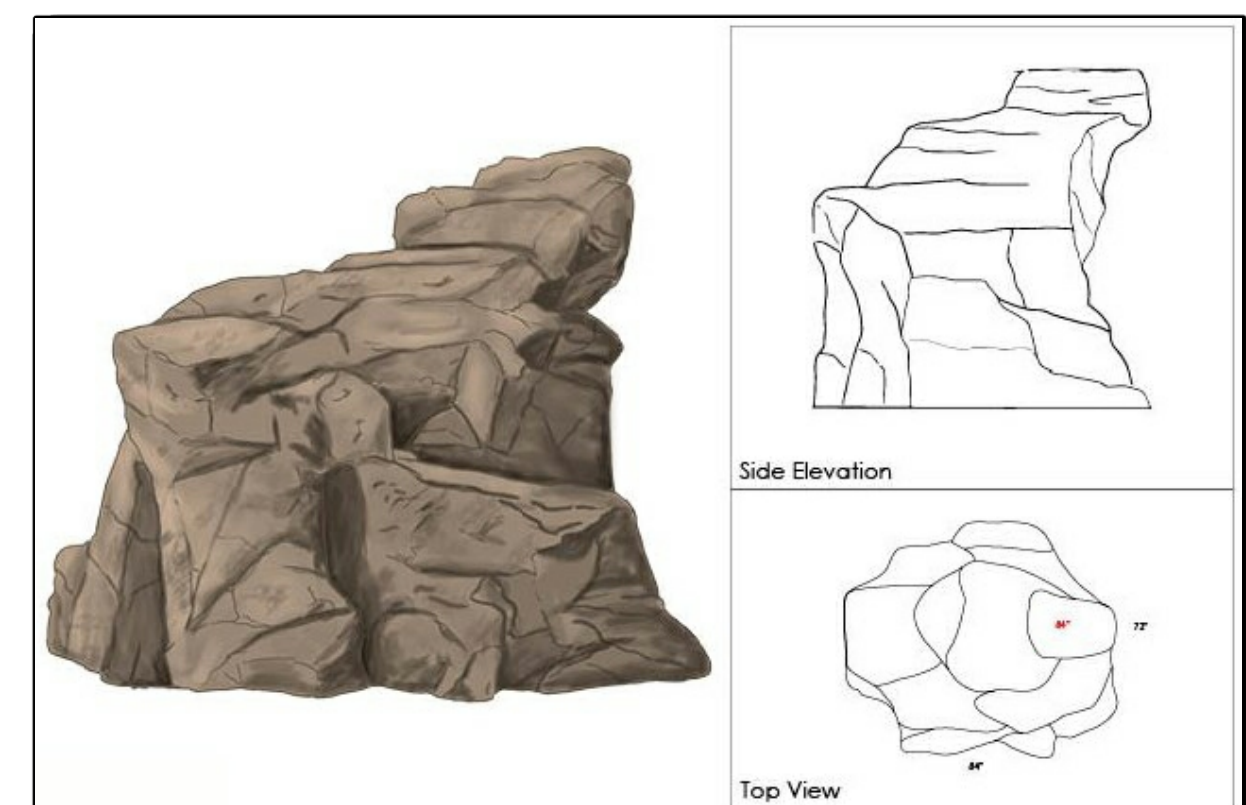



A

Easy-to-Install Clamps

Die cast aluminum clamps for precision fit and 360° compression. At Playworld Systems, we build them 10 times stronger than required.



B

PVC-Free Eco-Armor

Durable, thermoplastic coating for extra protection on high traffic areas is FREE from all harmful phthalates, lead, cadmium and dioxins.

C

Superior Rotomolded Plastic

We use compounded resins for reliable color consistency, UV stability and graffiti resistance. Greater impact resistance than dry-blended resins.























